

Self Build Sign System

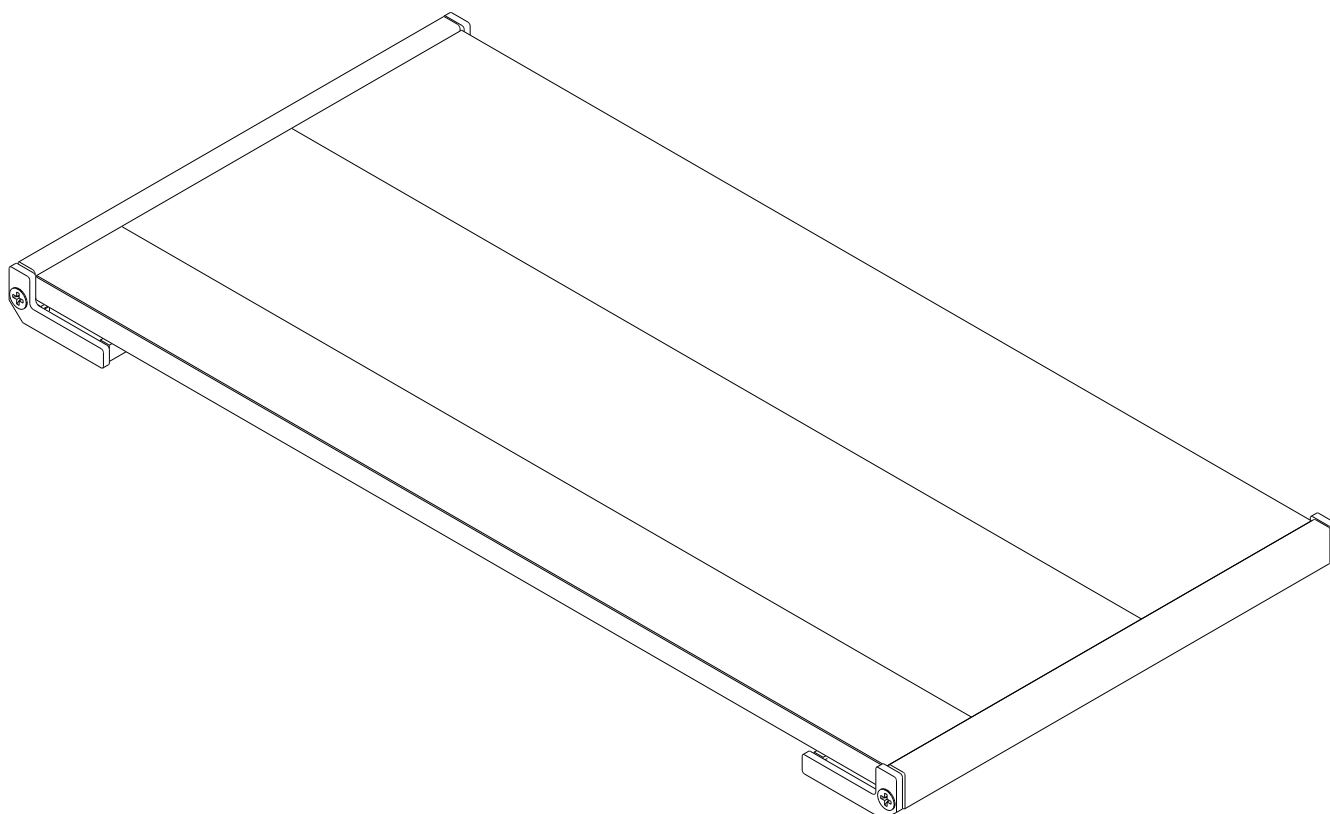

including **L&T** Directory System

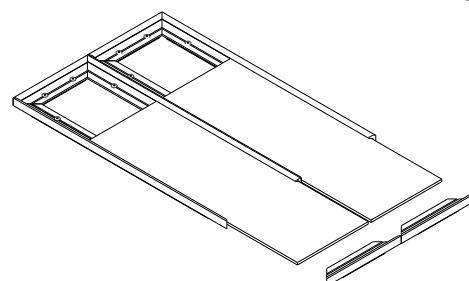

Technical Specification & Codes

EXTRUDED ALUMINIUM SIGNAGE SYSTEM

www.ashbytrade.net
+44 (0) 118 981 5343

K'NECT SLAT SYSTEM

The K'nect Slat System comprises a range of ten different extruded sections that combine to create three different, standard mounting methods; wall mounted, projecting and suspended.

The system's durable and robust design is best suited to directing people around large areas such as schools or hospitals. When finished it creates multi-level signs ideal for any directory project or job where signage must be consistent throughout the site. The discreet fixing system gives your signs a secure fixing method and tidy finish.

All components are kept in stock and are available on a same working day despatch.

As an alternative to a Self Build Sign System, these units can be supplied fully assembled but partially finished, powder coated to one of 107 stock RAL colours or fully finished complete with your graphics applied.

Please note that all prices are supplied in component form only, carriage charges and VAT have not been included.

Ashby Trade Sign Supplies is a manufacturer, designer and distributor of signage systems. Open longer for our customers' convenience, our products can be purchased either as components, partly finished or fully finished systems.

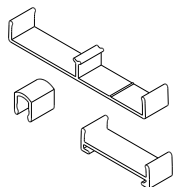

K'NECT SLAT EXTRUSION

There are 7 slat sizes available: 8mm (used as a dividing slat), 30mm, 60mm, 90mm, 120mm, 150mm and 210mm. Directory insert slats are also available in 30mm, 60mm and 90mm variants. All are stocked in a silver anodised finish.

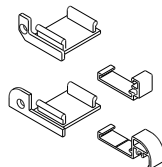

K'NECT WALL MOUNTED COMPONENTS

Comprising two wall mounting extruded components and four plastic injected parts.

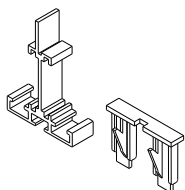

K'NECT SUSPENDED COMPONENTS

Comprising of one edge strip extrusion and one plastic end cap.

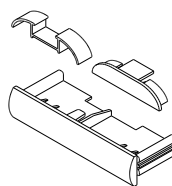

K'NECT PROJECTING COMPONENTS

Projecting components are used with slats of 90mm, 120mm and 150mm.

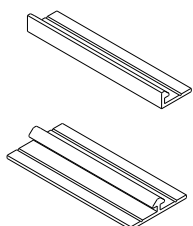

L & T DIRECTORY EXTRUSION

L & T Directory are most commonly rivetted or adhered to the face of signage to allow for an interchangeable or variable messaging system.

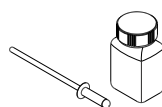

FIXINGS

A comprehensive list of all non-specific system components that are used throughout the range.

All Items sold are subject to the Standard Trading Terms of **Ashby Trade Sign Supplies Ltd.**
Copy on request or viewable at www.ashbytrade.net

Prices are correct at the time of printing and may be subject to change.

EXTRUDED ALUMINIUM SIGNAGE SYSTEM

www.ashbytrade.net
+44 (0) 118 981 5343

Paint References
White is Ral 9016 (Traffic White)



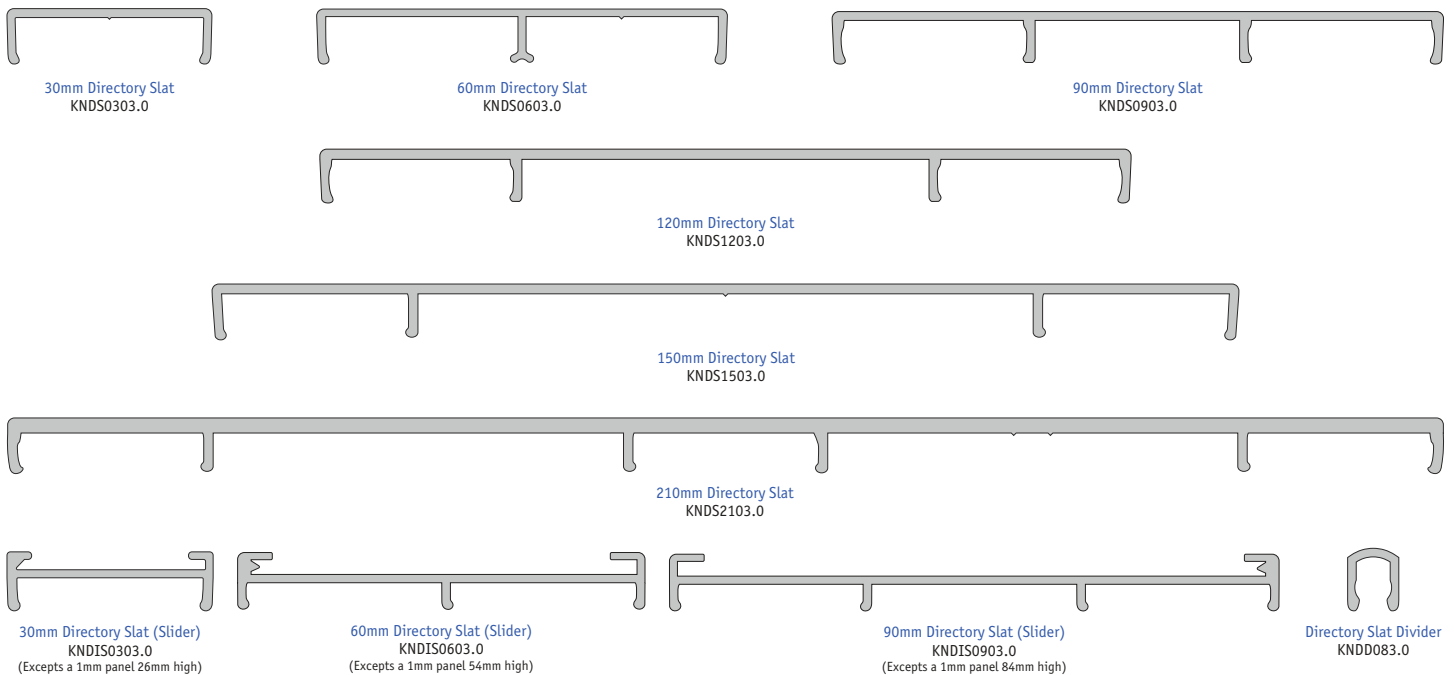

PRODUCT	CODE	MATERIAL	FINISH	LENGTH
30mm Directory Slat Dimensions: 30mm x 8mm	KNDS0303.0	ALUMINIUM 6063T6	Silver Anodised	3.00m
60mm Directory Slat Dimensions: 60mm x 8mm	KNDS0603.0	ALUMINIUM 6063T6	Silver Anodised	3.00m
90mm Directory Slat Dimensions: 90mm x 8mm	KNDS0903.0	ALUMINIUM 6063T6	Silver Anodised	3.00m
120mm Directory Slat Dimensions: 120mm x 8mm	KNDS1203.0	ALUMINIUM 6063T6	Silver Anodised	3.00m
150mm Directory Slat Dimensions: 150mm x 8mm	KNDS1503.0	ALUMINIUM 6063T6	Silver Anodised	3.00m
210mm Directory Slat Dimensions: 210mm x 8mm	KNDS2103.0	ALUMINIUM 6063T6	Silver Anodised	3.00m
30mm Directory Slat (Slider) Dimensions: 30mm x 8.5mm	KNDIS0303.0	ALUMINIUM 6063T6	Silver Anodised	3.00m
60mm Directory Slat (Slider) Dimensions: 60mm x 8.5mm	KNDIS0603.0	ALUMINIUM 6063T6	Silver Anodised	3.00m
90mm Directory Slat (Slider) Dimensions: 90mm x 8.5mm	KNDIS0903.0	ALUMINIUM 6063T6	Silver Anodised	3.00m
Directory Slat Divider Dimensions: 8mm x 9mm	KNDD083.0	ALUMINIUM 6063T6	Silver Anodised	3.00m

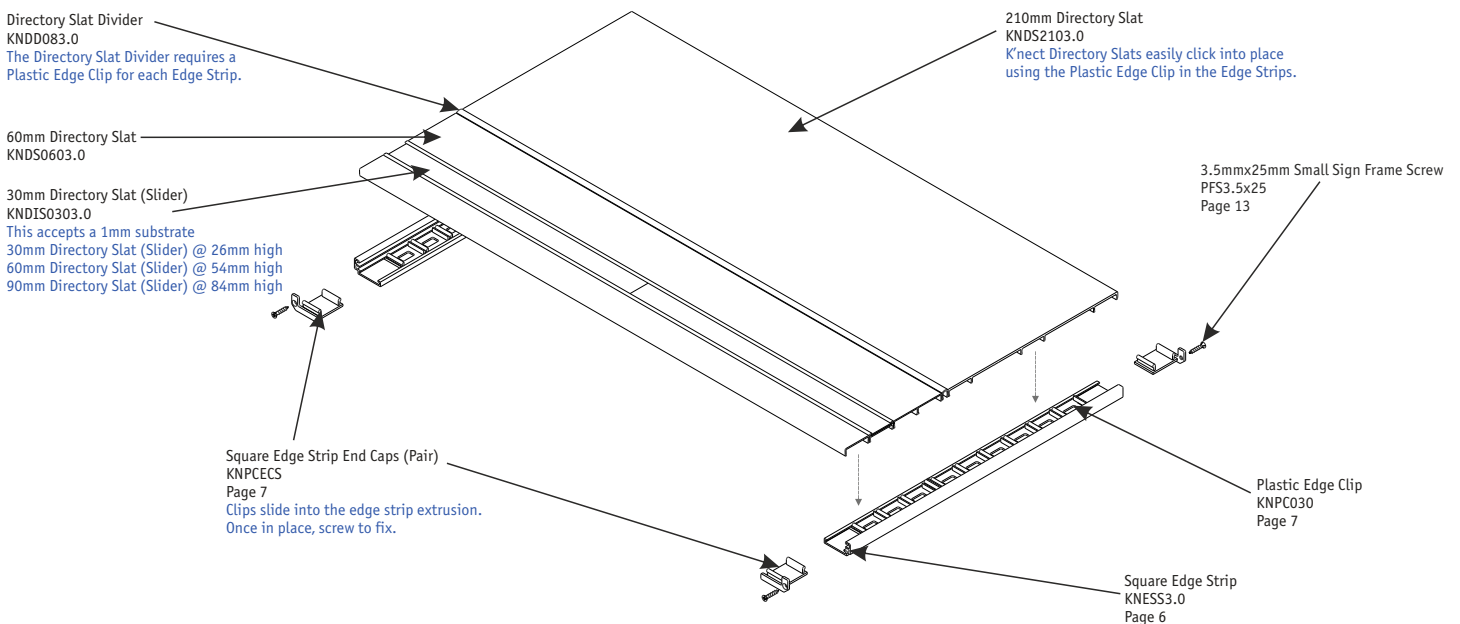

EXTRUDED ALUMINIUM SIGNAGE SYSTEM

www.ashbytrade.net
+44 (0) 118 981 5343

Tools required to cut the slat extrusion and drill holes in the edge strip for wall mounting.
Screw the edge strip caps in place.



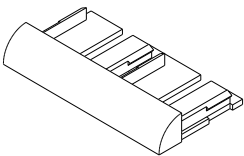

60mm Wall Mounting End caps
KNWMEC060

PRODUCT	CODE	MATERIAL	FINISH
60mm Wall Mounting End caps Dimensions: 61mm x 33mm x 10mm	KNWMEC060	PLASTIC	Black

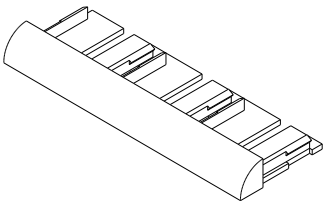

90mm Wall Mounting End caps
KNWMEC090

PRODUCT	CODE	MATERIAL	FINISH
90mm Wall Mounting End caps Dimensions: 91mm x 33mm x 10mm	KNWMEC090	PLASTIC	Black

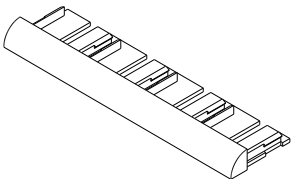

120mm Wall Mounting End caps
KNWMEC120

PRODUCT	CODE	MATERIAL	FINISH
120mm Wall Mounting End caps Dimensions: 121mm x 33mm x 10mm	KNWMEC120	PLASTIC	Black

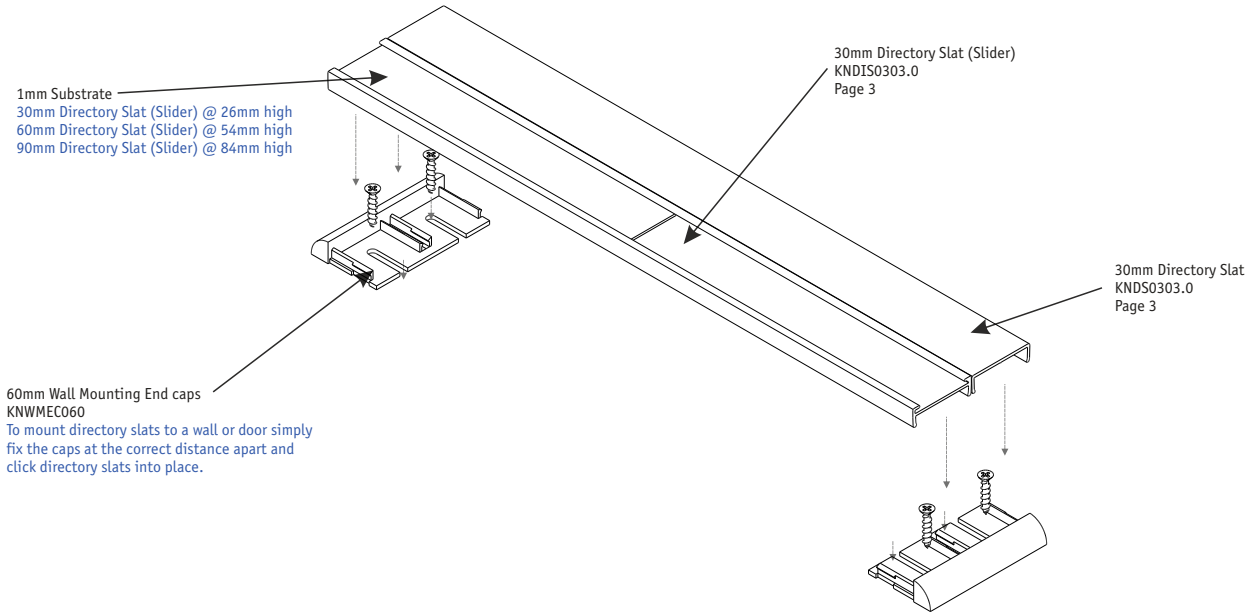

EXTRUDED ALUMINIUM SIGNAGE SYSTEM

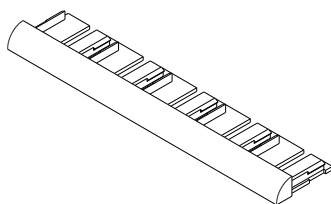

150mm Wall Mounting End caps
KNWMEC150

PRODUCT	CODE	MATERIAL	FINISH
150mm Wall Mounting End caps Dimensions: 151mm x 33mm x 10mm	KNWMEC150	PLASTIC	Black

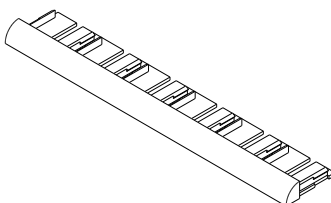

180mm Wall Mounting End caps
KNWMEC180

PRODUCT	CODE	MATERIAL	FINISH
180mm Wall Mounting End caps Dimensions: 181mm x 33mm x 10mm	KNWMEC180	PLASTIC	Black

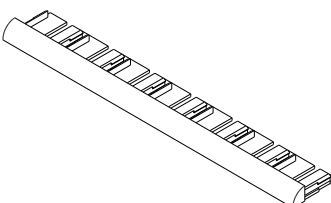

210mm Wall Mounting End caps
KNWMEC210

PRODUCT	CODE	MATERIAL	FINISH
210mm Wall Mounting End caps Dimensions: 211mm x 33mm x 10mm	KNWMEC210	PLASTIC	Black

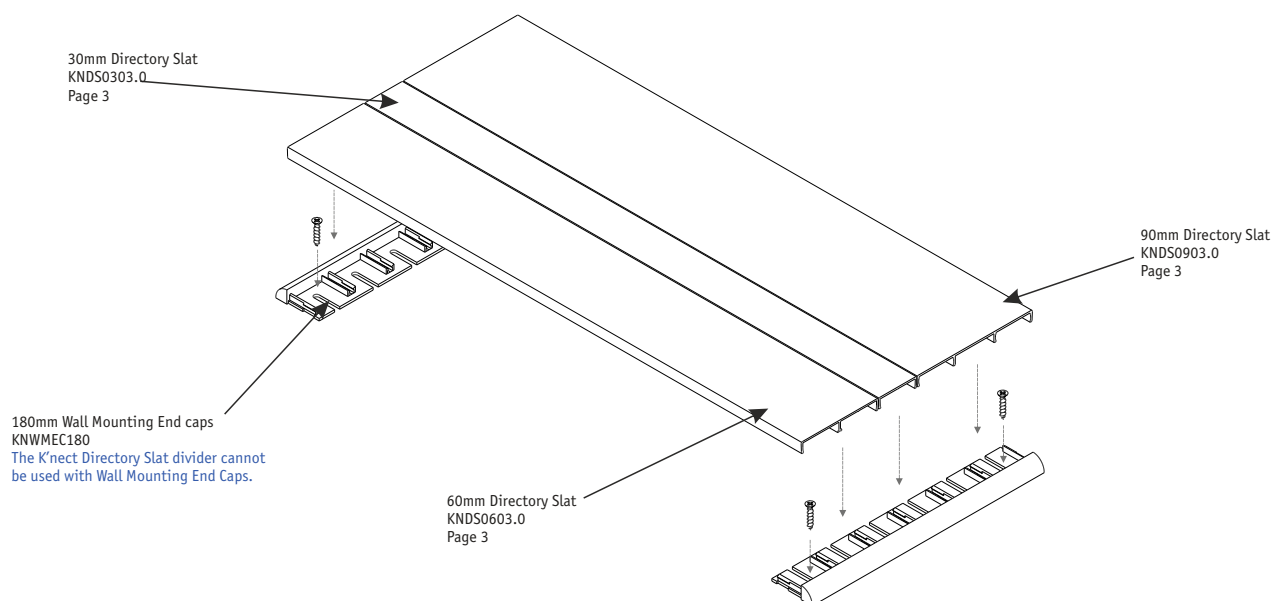

EXTRUDED ALUMINIUM SIGNAGE SYSTEM

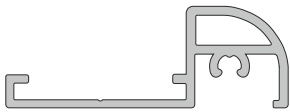

Quadrant Edge Strip (Bevel)
KNESB3.0

PRODUCT	CODE	MATERIAL	FINISH	LENGTH
Quadrant Edge Strip Dimensions: 41mm x 15mm	KNESB3.0	ALUMINIUM 6063T6	Silver Anodised	3.00m

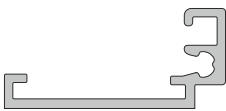

Square Edge Strip
KNES3.0

PRODUCT	CODE	MATERIAL	FINISH	LENGTH
Square Edge Strip Dimensions: 32mm x 15mm	KNES3.0	ALUMINIUM 6063T6	Silver Anodised	3.00m

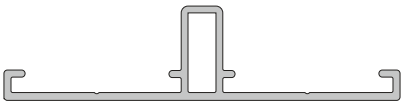

Central Square Edge Strip
KNCD3.0

PRODUCT	CODE	MATERIAL	FINISH	LENGTH
Central Square Edge Strip Dimensions: 58mm x 14mm	KNCD3.0	ALUMINIUM 6063T6	Silver Anodised	3.00m

Directory Slat Divider
KNDD083.0
Page 3

30mm Directory Slat
KNDS0303.0
Page 3

Quadrant Edge Strip End Caps (Pair)
KNPCECB
Page 7

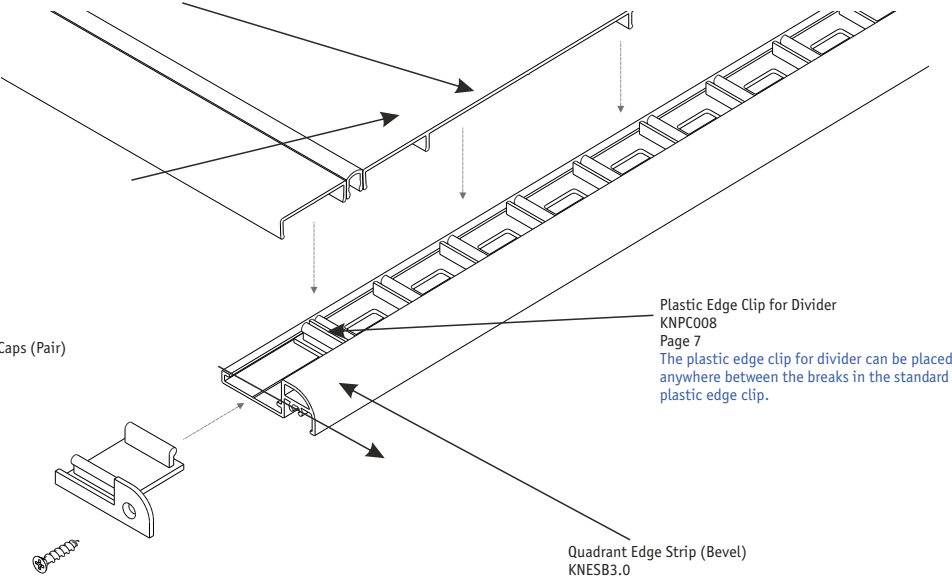

EXTRUDED ALUMINIUM SIGNAGE SYSTEM

www.ashbytrade.net
+44 (0) 118 981 5343

Tools required to cut the Slat Extrusion
and drill holes in the edge strip for
wall mounting.
Screw the edge strip into place.



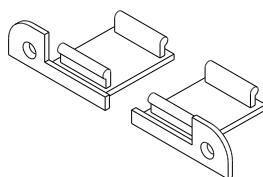

Requires
2x 3.5mmx25mm Small
Sign Frame Screw
PFS3.5x25 (Page 13)

Quadrant Edge Strip End Caps (Pair)
KNPCECB

PRODUCT	CODE	MATERIAL	FINISH
Quadrant Edge Strip End Caps Dimensions: 41mm x 15mm x 32mm	KNPCECB	PLASTIC	Black

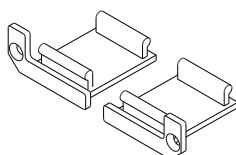

Requires
2x 3.5mmx25mm Small
Sign Frame Screw
PFS3.5x25 (Page 13)

Square Edge Strip End Caps (Pair)
KNPCECS

PRODUCT	CODE	MATERIAL	FINISH
Square Edge Strip End Caps Dimensions: 33mm x 15mm x 32mm	KNPCECS	PLASTIC	Black

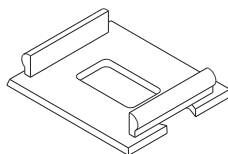

Plastic Edge Clip
KNPC030

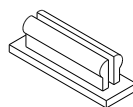

Plastic Edge Clip for Divider
KNPC008

PRODUCT	CODE	MATERIAL	FINISH
Plastic Edge Clip Dimensions: 30mm x 24.5mm x 6.7mm	KNPC030	PLASTIC	Black
Plastic Edge Clip for Divider Dimensions: 24.5mm x 7.4mm x 7.7mm	KNPC008	PLASTIC	Black

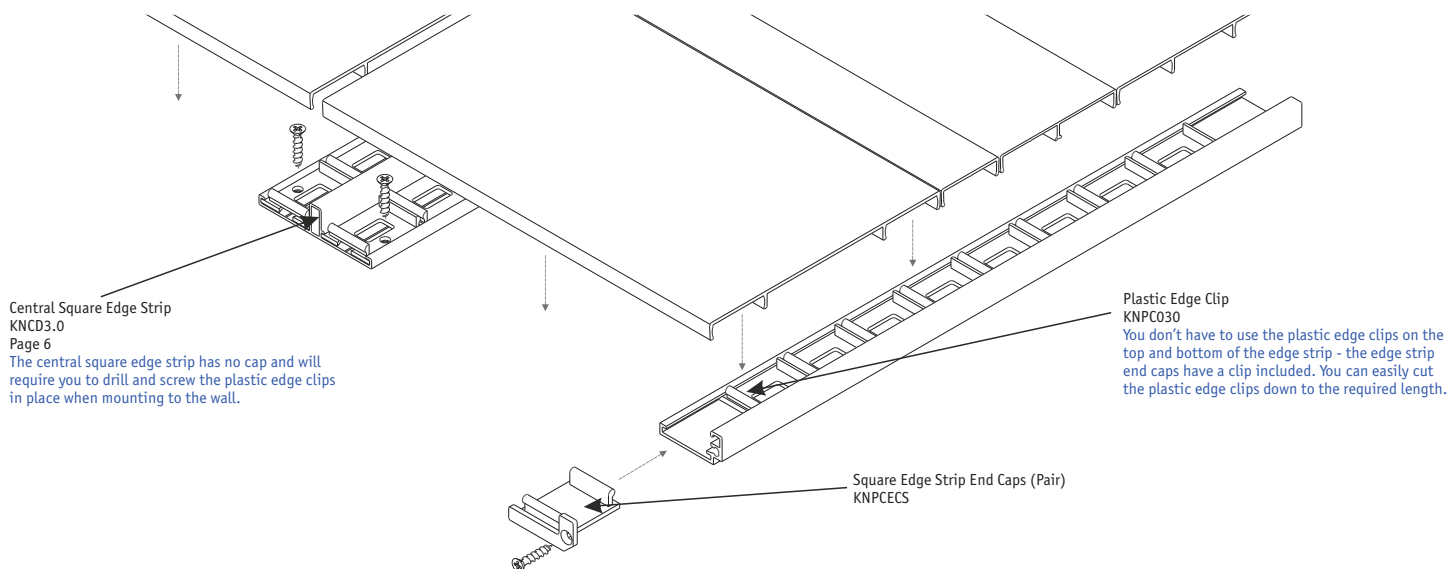

EXTRUDED ALUMINIUM SIGNAGE SYSTEM

www.ashbytrade.net
+44 (0) 118 981 5343

Tools required to fit
Quadrant/Square Edge Strip End Caps (Plastic)
to edge strip extrusion



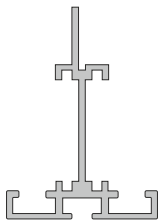

Suspended Edge Strip
KNSES3.0

PRODUCT	CODE	MATERIAL	FINISH	LENGTH
Suspended Edge Strip Dimensions: 31mm x 44mm	KNSES3.0	ALUMINIUM 6063T6	Silver Anodised	3.00m

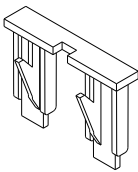

Suspended Edge Strip End Cap
KNECS

PRODUCT	CODE	MATERIAL	FINISH
Suspended Edge Strip End Cap Dimensions: 31mm x 6mm x 26mm	KNECS	PLASTIC	Black

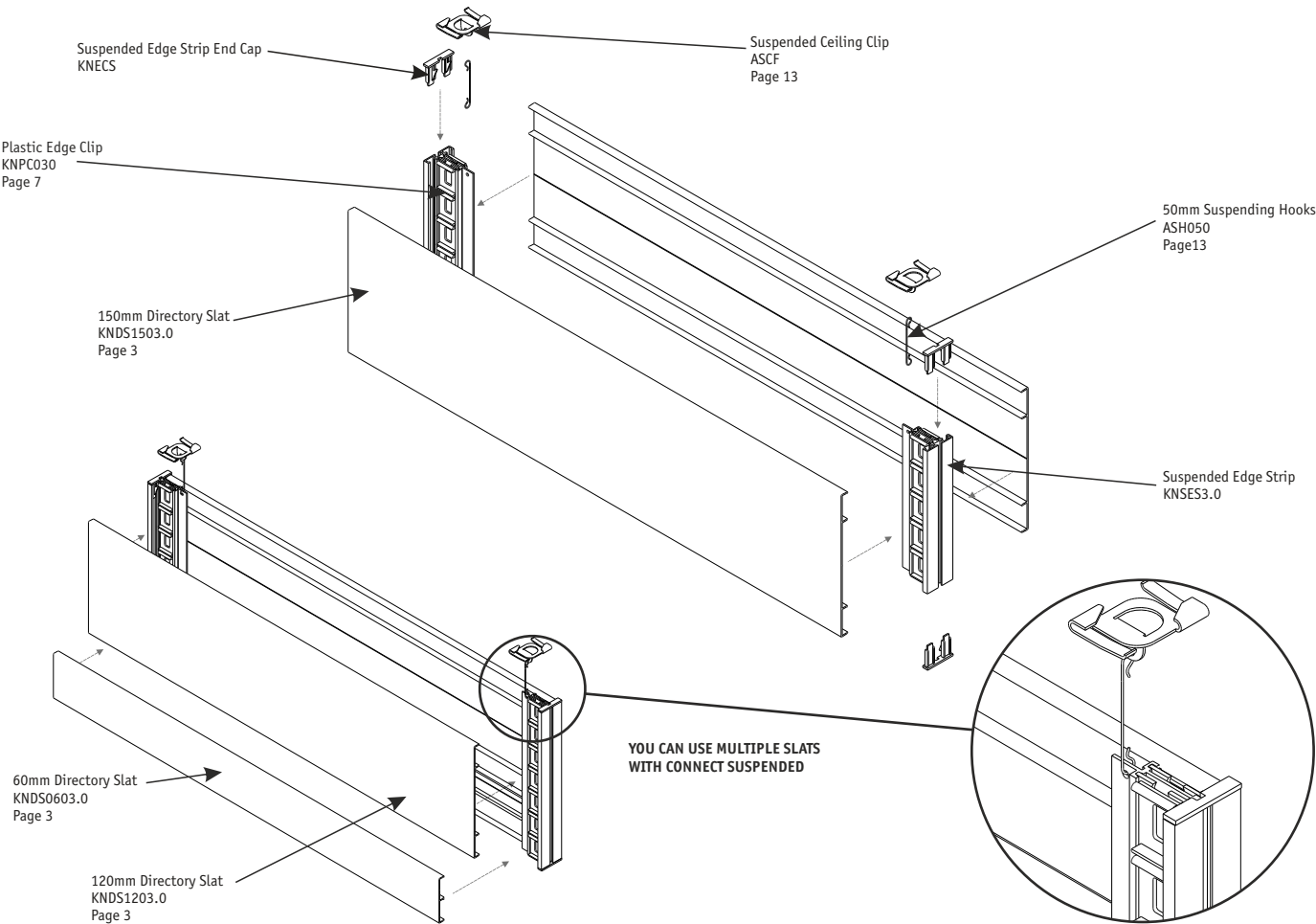

EXTRUDED ALUMINIUM SIGNAGE SYSTEM

www.ashbytrade.net
+44 (0) 118 981 5343

Tools required to Cut the Slat Extrusion
and the suspended edge extrusion.
Drill the holes for hanging hole.
Everything else will clip into place.





Projecting Base Extrusion
KNPBE3.0

PRODUCT	CODE	MATERIAL	FINISH	LENGTH
Projecting Edge Strip Dimensions: 31mm x 44mm	KNPBE3.0	ALUMINIUM 6063T6	Silver Anodised	3.00m

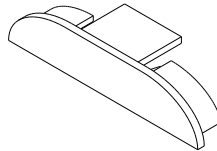

Projecting Base End Cap
KNPBEC

PRODUCT	CODE	MATERIAL	FINISH
Projecting Edge Strip End Cap Dimensions: 31mm x 6mm x 26mm	KNPBEC	PLASTIC	Black

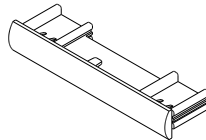

90mm Projecting Slat End Cap
KNECP090

PRODUCT	CODE	MATERIAL	FINISH
90mm Projecting Slat End Cap Dimensions: 90mm x 19mm x 35mm	KNECP090	PLASTIC	Black

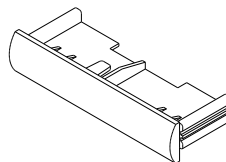

120mm Projecting Slat End Cap
KNECP120

PRODUCT	CODE	MATERIAL	FINISH
120mm Projecting Slat End Cap Dimensions: 120mm x 19mm x 35mm	KNECP120	PLASTIC	Black

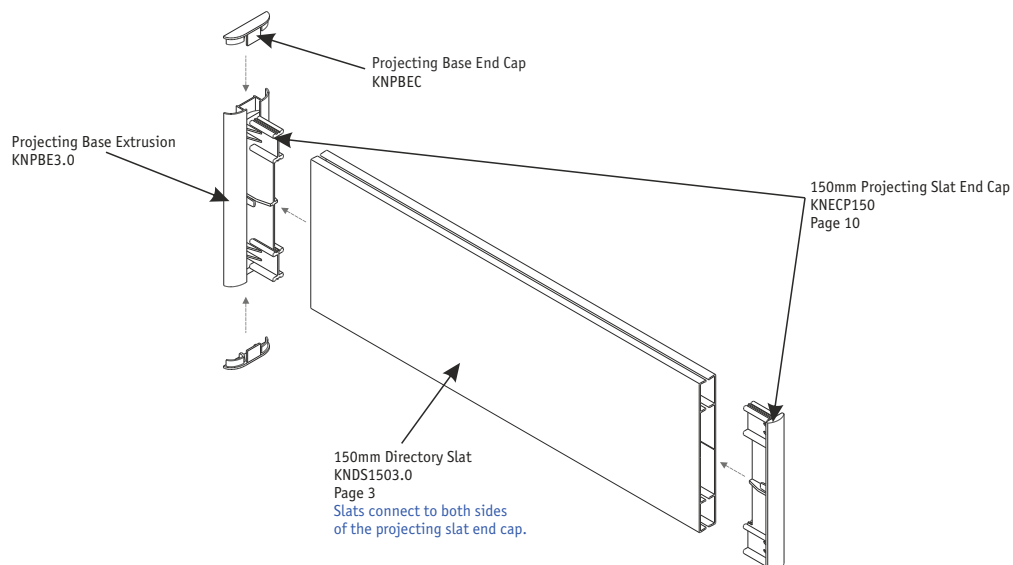

EXTRUDED ALUMINIUM SIGNAGE SYSTEM

www.ashbytrade.net
+44 (0) 118 981 5343

Tools required to cut the slat extrusion and the projecting base extrusion. Drill holes in projecting base extrusion for wall mounting.



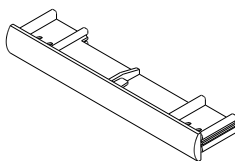

150mm Projecting Slat End Cap
KNECP150

PRODUCT	CODE	MATERIAL	FINISH
150mm Projecting Slat End Cap Dimensions: 150mm x 19mm x 35mm	KNECP150	PLASTIC	Black

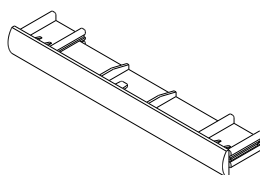

180mm Projecting Slat End Cap
KNECP180

PRODUCT	CODE	MATERIAL	FINISH
180mm Projecting Slat End Cap Dimensions: 180mm x 19mm x 35mm	KNECP180	PLASTIC	Black

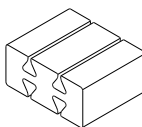

Slat Joining Clip
KNPSJC

PRODUCT	CODE	MATERIAL	FINISH
Slat Joining Clip Dimensions: 22mm x 10mm x 18mm	KNPSJC	PLASTIC	Black

Projecting Base Extrusion KNPBE3.0

Page 9

The length of the projecting base extrusion is always the height of the projecting slat end cap plus 24mm.

Slat Joining Clip KNPSJC

The slat joining clips are required with the projecting system only (one clip is necessary, per join, at each end of the projecting sign).

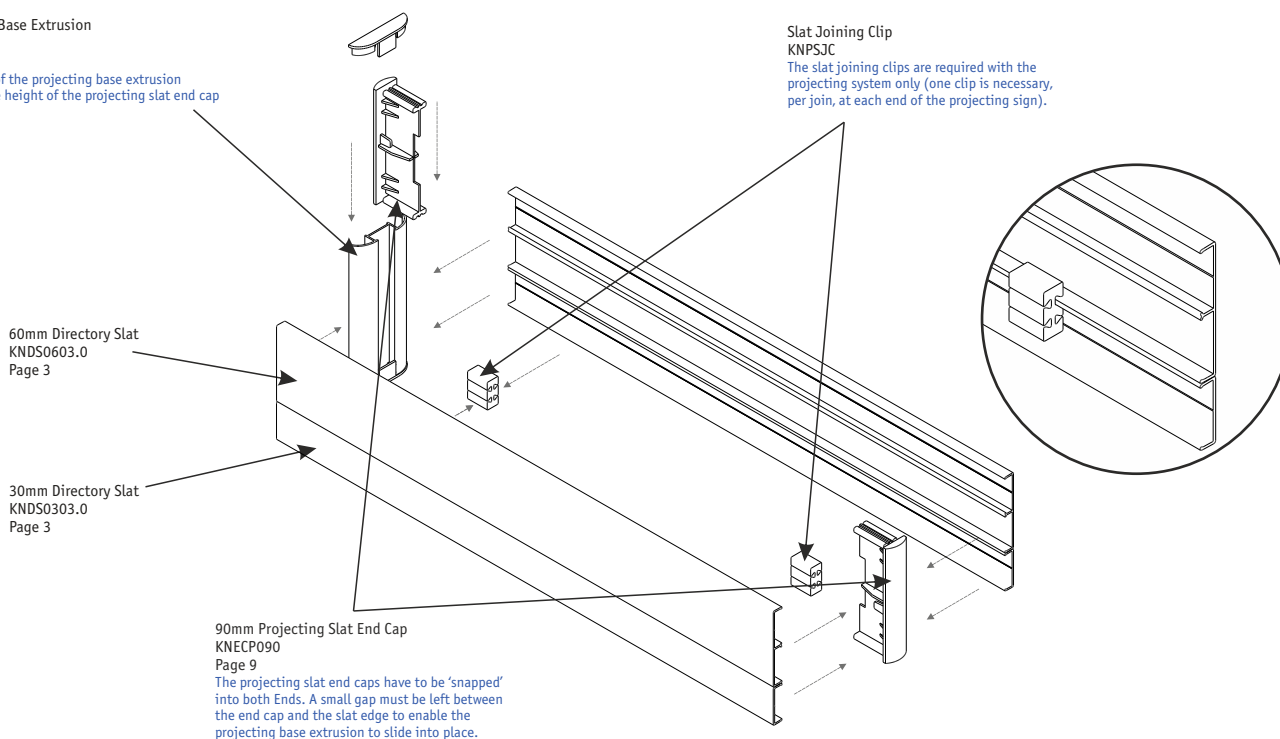

EXTRUDED ALUMINIUM SIGNAGE SYSTEM

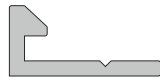

'L' Directory Extrusion
DIYDIRLA3.0/DIYDIRLW3.0

PRODUCT	CODE	MATERIAL	FINISH	LENGTH
'L' Directory Extrusion Dimensions: 20mm x 9mm	DIYDIRLA3.0	ALUMINIUM 6063T6	Silver Anodised	3.00m
	DIYDIRLW3.0		White	3.00m

REQUIRES THE USE OF 'L' DIRECTORY ONLY

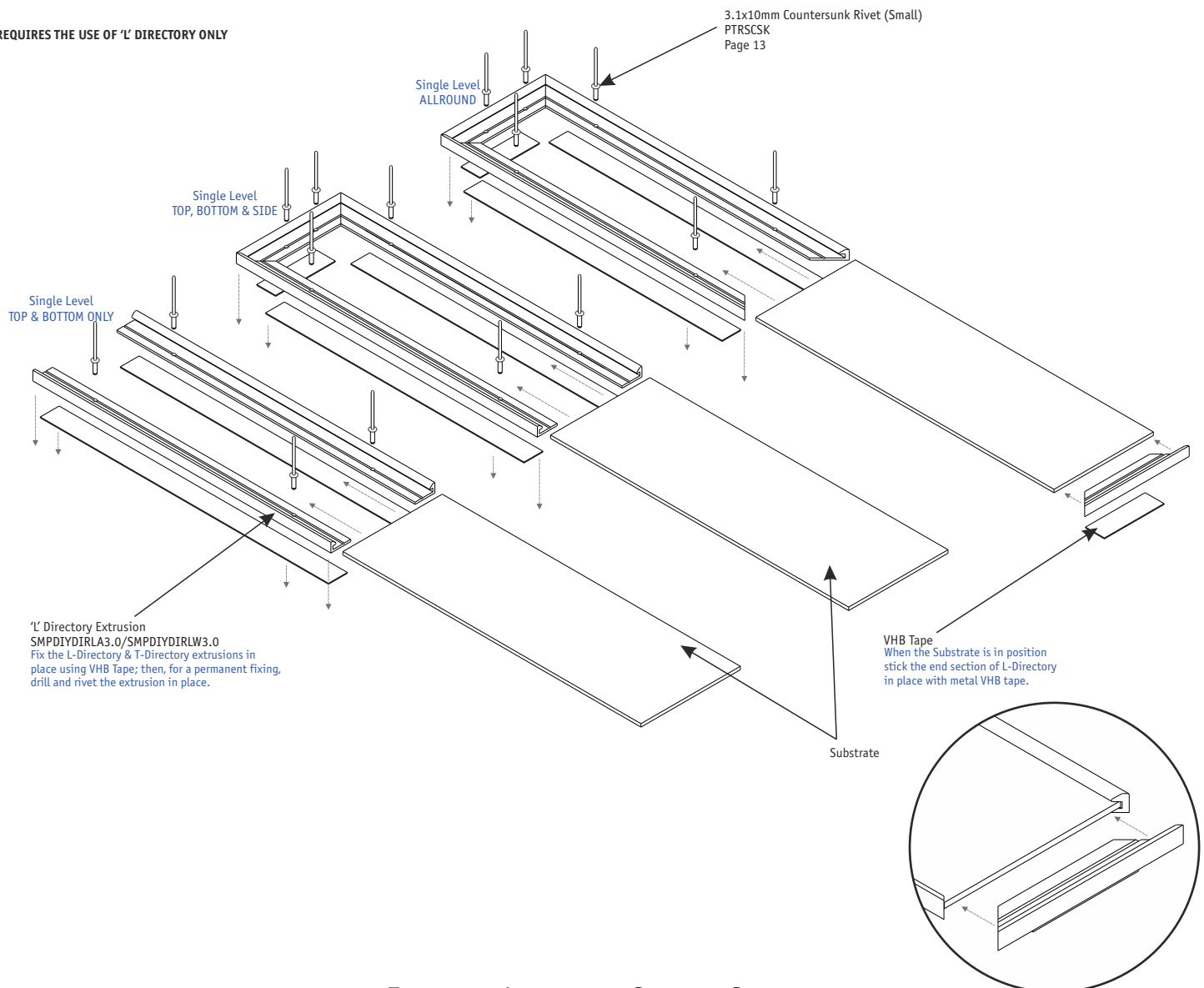

EXTRUDED ALUMINIUM SIGNAGE SYSTEM

www.ashbytrade.net
+44 (0) 118 981 5343

Tools required to Cut the 'L' Directory
extrusion and drill holes (6mm)
through the extrusion and your
substrate, then rivet in position.





T' Directory Extrusion
DIYDIRTA3.0/DIYDIRTW3.0

PRODUCT	CODE	MATERIAL	FINISH	LENGTH
T' Directory Extrusion Dimensions: 40mm x 9mm	DIYDIRTA3.0	ALUMINIUM 6063T6	Silver Anodised	3.00m
	DIYDIRTW3.0		White	3.00m

REQUIRES THE USE OF BOTH THE 'L' & 'T' DIRECTORY

'L' Directory Extrusion
DIYDIRLA3.0/DIYDIRLW3.0
Page 11

Fix the L-Directory & T-Directory extrusions in place using VHB Tape; then drill and rivet the extrusion in place.

T' Directory Extrusion
DIYDIRTA3.0/DIYDIRTW3.0
The T' Directory Extrusion is for Multi Level Slider Directories.

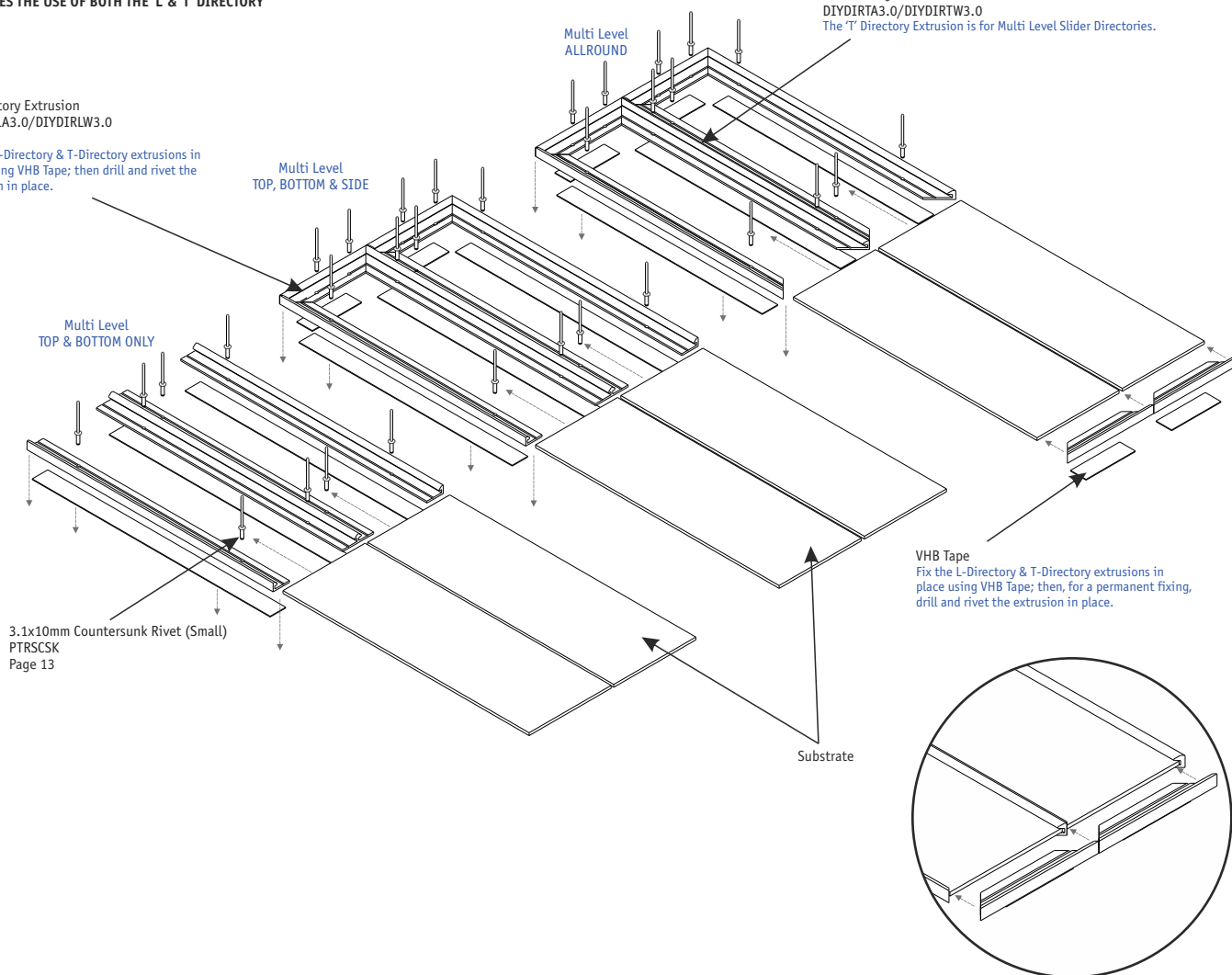

EXTRUDED ALUMINIUM SIGNAGE SYSTEM

www.ashbytrade.net
+44 (0) 118 981 5343

Tools required to Cut the T' Directory extrusion and drill holes (6mm) through the extrusion and your substrate, then rivet in position.



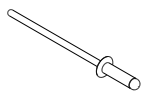

3.1x10mm Countersunk Rivet (Small)
PTRSCSK



3.5mmx25mm Small Sign Frame Screw
PFS35x25

PRODUCT	CODE	MATERIAL	FINISH
3.1x10mm Countersunk Rivet (Small)	PTRSCSK	ALUMINIUM	Silver
3.5mmx25mm Small Sign Frame Screw	PFS3.5x25	STAINLESS STEEL	Silver

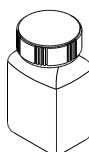

Pot of Touch Up Paint (70ml)
TUPW/B/G

PRODUCT	CODE	FINISH
Pot of Touch Up Paint (70ml)	TUPW	White
	TUPB	Black
	TUPG	Standard Ral

Please Note that these items will require 2-3 day lead time (excess charges may apply).



25mm Suspending Hooks
ASH025



50mm Suspending Hooks
ASH050



150mm Suspending Hooks
ASH150



400mm Suspending Hooks
ASH400

PRODUCT	CODE	MATERIAL	FINISH
25mm Suspending Hooks	ASH025	STEEL	Silver
50mm Suspending Hooks	ASH050	STEEL	Silver
150mm Suspending Hooks	ASH150	STEEL	Silver
400mm Suspending Hooks	ASH400	STEEL	Silver



Suspended Ceiling Clip
ASCF
(Suitable for suspended ceilings)

PRODUCT	CODE	MATERIAL	FINISH
Suspended Ceiling Clip	ASCF	STEEL	White

DIFFERENT WAYS TO CREATE L&T DIRECTORY SLIDER SYSTEMS

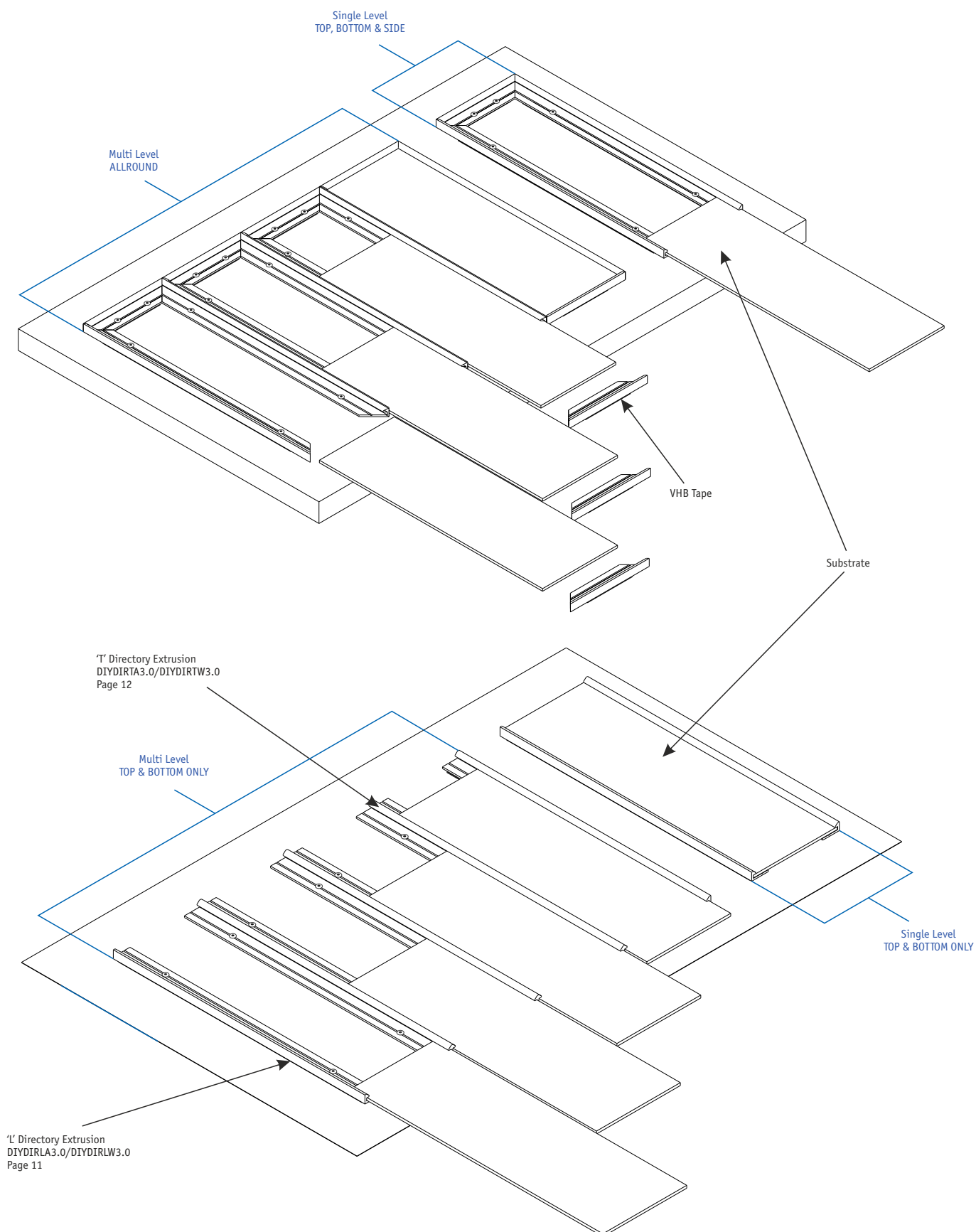

EXTRUDED ALUMINIUM SIGNAGE SYSTEM

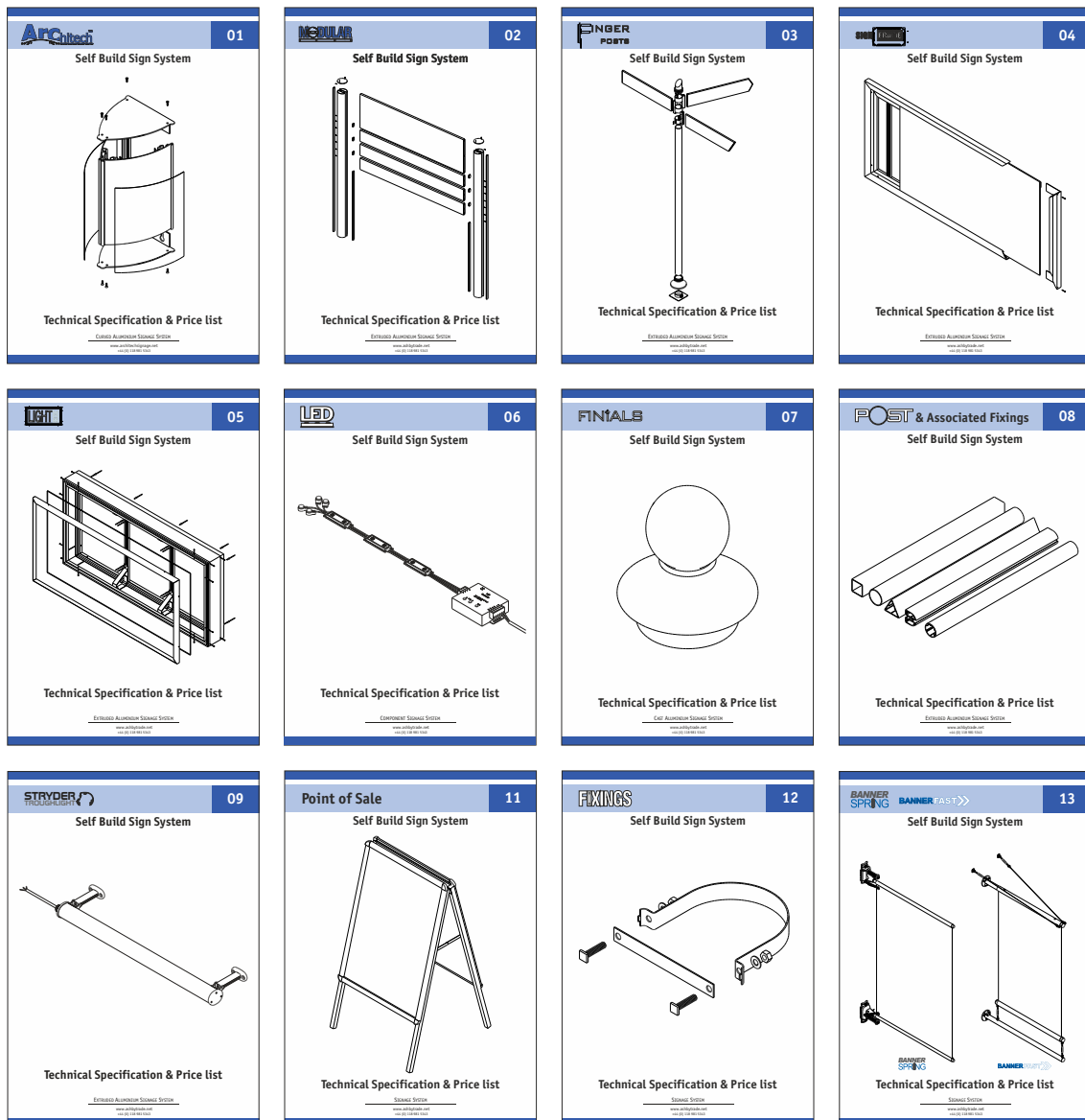

EXTRUDED ALUMINIUM SIGNAGE SYSTEM

www.ashbytrade.net
+44 (0) 118 981 5343

Paper Size Guide

Size	Millimetres
A6	105mm x 148mm
A5	148mm x 210mm
A4	210mm x 297mm
A3	297mm x 420mm
A2	420mm x 594mm
A1	594mm x 841mm
A0	841mm x 1189mm

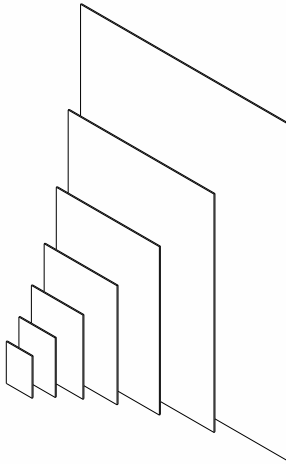

British SWG (Standard Wire Gauge) Table

SWG	Millimetres	SWG	Millimetres
7/0	12.700mm	23	0.610mm
6/0	11.786mm	24	0.559mm
5/0	10.973mm	25	0.5080mm
4/0	10.160mm	26	0.4572mm
3/0	9.449mm	27	0.4166mm
2/0	8.839mm	28	0.3759mm
0	8.230mm	29	0.3454mm
1	7.620mm	30	0.3150mm
2	7.010mm	31	0.2946mm
3	6.401mm	32	0.2743mm
4	5.893mm	33	0.2540mm
5	5.385mm	34	0.2337mm
6	4.877mm	35	0.2134mm
7	4.470mm	36	0.1930mm
8	4.064mm	37	0.1727mm
9	3.658mm	38	0.1524mm
10	3.251mm	39	0.1321mm
11	2.946mm	40	0.1219mm
12	2.642mm	41	0.1118mm
13	2.337mm	42	0.1016mm
14	2.032mm	43	0.0914mm
15	1.829mm	44	0.0813mm
16	1.626mm	45	0.0711mm
17	1.422mm	46	0.0610mm
18	1.219mm	47	0.0508mm
19	1.016mm	48	0.0406mm
20	0.914mm	49	0.0305mm
21	0.813mm	50	0.0254mm
22	0.711mm		

Feet to Millimetres Table

Feet	Millimetres	Feet	Millimetres
1	304.80mm	11	3352.8mm
2	609.60mm	12	3657.6mm
3	914.40mm	13	3962.4mm
4	1219.2mm	14	4267.2mm
5	1524.0mm	15	4572.0mm
6	1828.8mm	16	4876.8mm
7	2133.6mm	17	5181.6mm
8	2438.4mm	18	5486.4mm
9	2743.2mm	19	5791.2mm
10	3048.0mm	20	6096.0mm

Inches to Millimetres Table

Inches	Millimetres	Inches	Millimetres
1	25.400mm	15	381.00mm
2	50.800mm	16	406.40mm
3	76.200mm	17	431.80mm
4	101.60mm	18	457.20mm
5	127.00mm	19	482.60mm
6	152.40mm	20	508.00mm
7	177.80mm	21	533.40mm
8	203.20mm	22	558.80mm
9	228.60mm	23	584.20mm
10	254.00mm	24	609.60mm
11	279.40mm	25	635.00mm
12	304.80mm	26	660.40mm
13	330.20mm	27	685.80mm
14	355.60mm	28	711.20mm

Viewing Distances

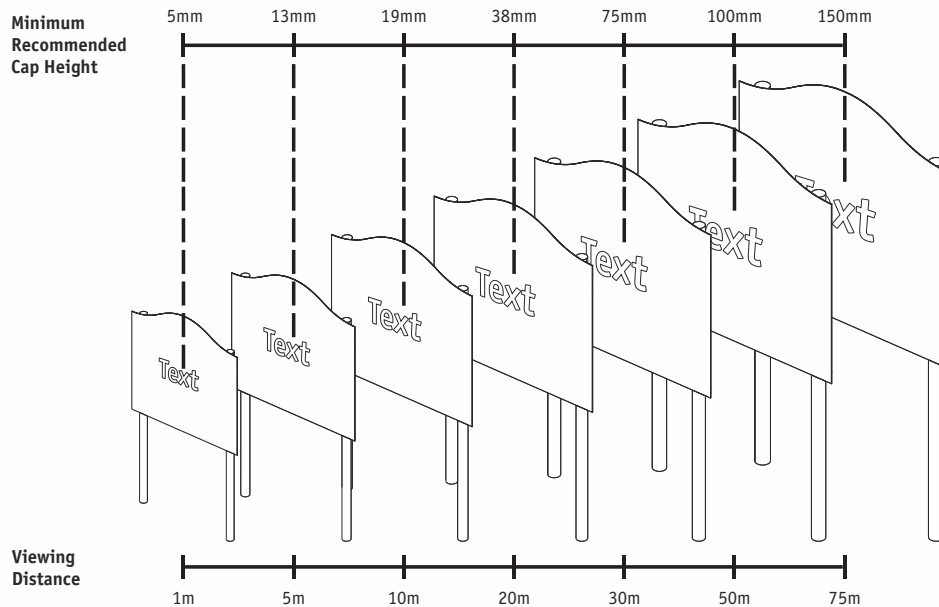

This should be used as a guide as this can vary with text styles, colours and contrasts.

Ashby[™]
Trade Sign Supplies

Ashby Trade Sign Supplies Ltd
Unit 1
Hatch Industrial Park
Basingstoke
RG24 7NG

Registered in England No. 1439528

Tel: 0118 981 5343
sales@ashbytrade.co.uk
www.ashbytrade.net

Registered Office: As Above